

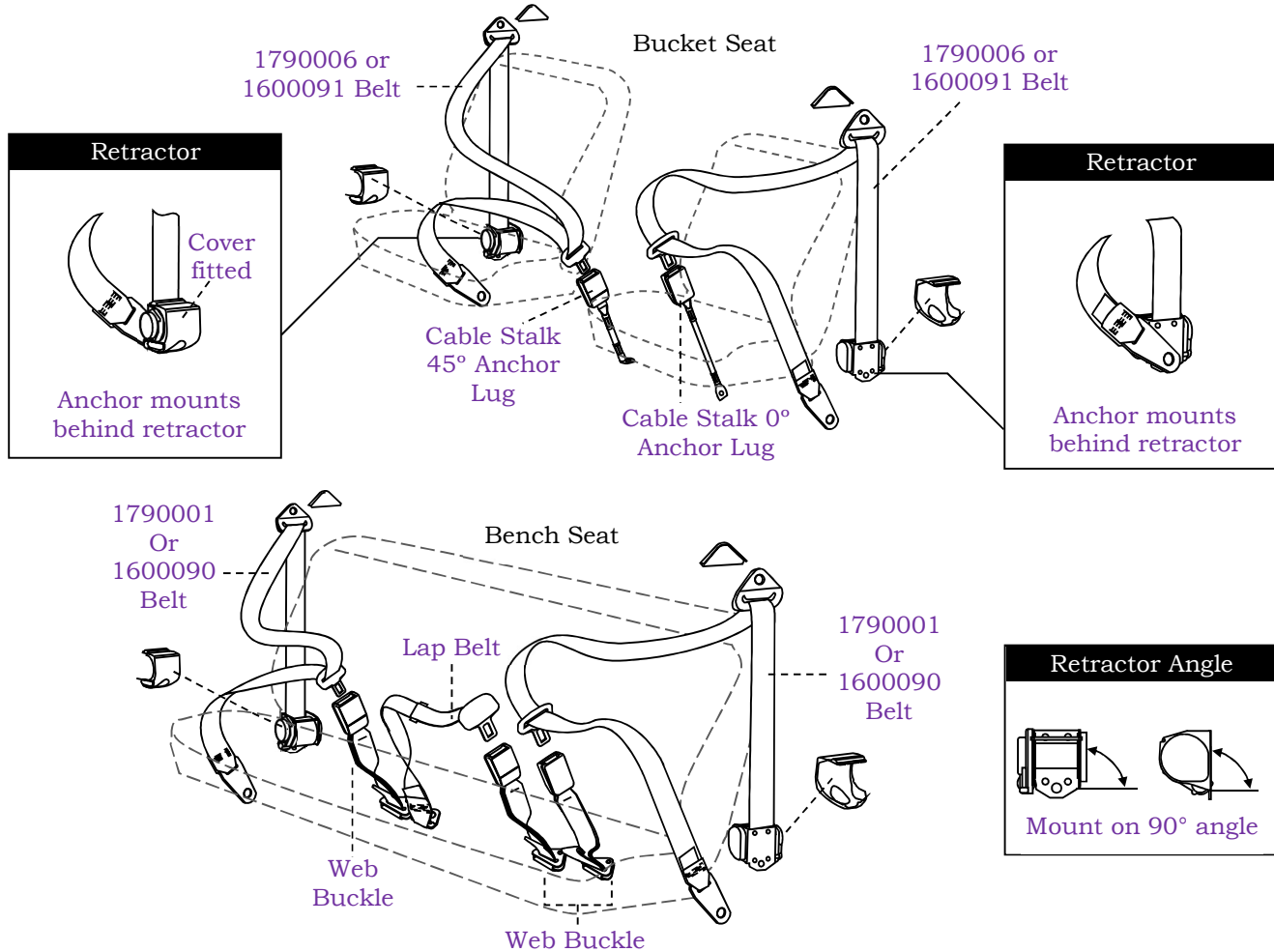

FJ – HZ HOLDEN FRONT SEAT BELTS



Seat Belt Assembly Part Numbers

Belt Part Number	Belt Type	Seating	Position	Bolt Thread	Buckle Type	Buckle Part Number	Buckle Length
1790001	Inertia Lap Sash	Bench Seat	Driver or Passenger	7/16 Unf	Webbing	1765400	Adjustable 200mm-600mm
1790006	Inertia Lap Sash	Bucket Seat	Driver or Passenger	7/16 Unf	Stalk	See Buckle Table Pg. 2	See Buckle Table Pg. 2
1600090	Inertia Lap Sash	Bench Seat	Driver or Passenger	½ Inch	Webbing	1765400	Adjustable 200mm-600mm
1600091	Inertia Lap Sash	Bucket Seat	Driver or Passenger	½ Inch	Stalk	See Buckle Table Pg. 2	See Buckle Table Pg. 2
1600200	Static Lap	Bench Seat	Centre	7/16 Unf	Webbing	1765400	Adjustable 200mm-600mm
1600203	Static Lap	Bench Seat	Centre	½ Inch	Webbing	1765400	Adjustable 200mm-600mm

Note:

Ensure the **correct bolt thread** is identified or known when selecting seat belts.

HEMCO INDUSTRIES PTY LTD

OCCUPANT RESTRAINTS

ABN 12 004 746 856



Australian Standard
AS/NZS2596 Lic 895
SAI Global

FJ – HZ HOLDEN FRONT SEAT BELTS CONT'D

7/16 unf Cable Stalk Buckle Part Numbers								
Buckle Type & Position	Buckle Lengths							
	250mm	300mm	350mm	400mm	450mm	500mm	550mm	600mm
0° Lug Driver or Passenger	1766016	1766020	1766027	1766032	1766040	1766046	1766050	1766054
45° Lug Passenger	1766019	1766023	1766030	1766035	1766042	1766048	1766052	1766056
45° Lug Driver	1766018	1766022	1766029	1766034	1766041	1766047	1766051	1766055

Note:
The below **1766027** example selection can be made by the following steps.
1. Choose a buckle type from the left hand column – **eg. 0° Lug Driver or Passenger**
2. Move along the corresponding row till you reach a suitable length – **eg. 350mm**
This should give a result of part number **1766027** as highlighted in the table.

0° Lug – Can be mounted to the side of the transmission tunnel.
45° Lug – Can be mounted to the floor

1766027 – 350mm Cable Stalk

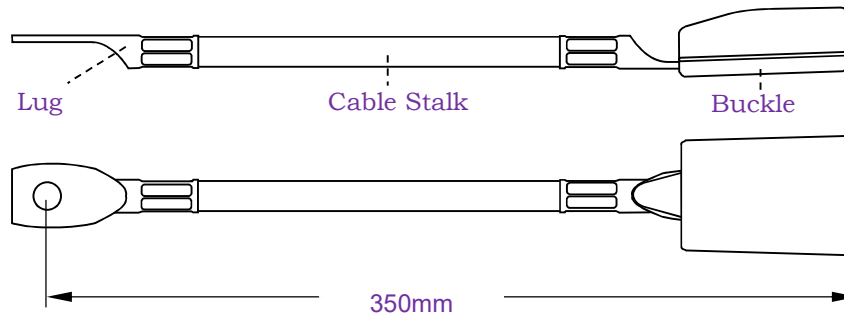

½ Inch Cable Stalk Buckle Part Numbers					
Buckle Type & Position	Buckle Lengths				
	230mm	300mm	330mm	350mm	400mm
0° Lug Driver or Passenger	1766014	-	1766026	-	1766033
45° Lug Passenger	-	1766099	-	1766097	1766090
45° Lug Driver	-	1766098	-	1766096	1766089