

HEMCO INDUSTRIES PTY LTD

OCCUPANT RESTRAINTS

ABN 12 004 746 856



Australian Standard
AS/NZS2596 Lic 895
SAI Global

1600204 1/2 INCH STATIC LAP SASH SEAT BELTS

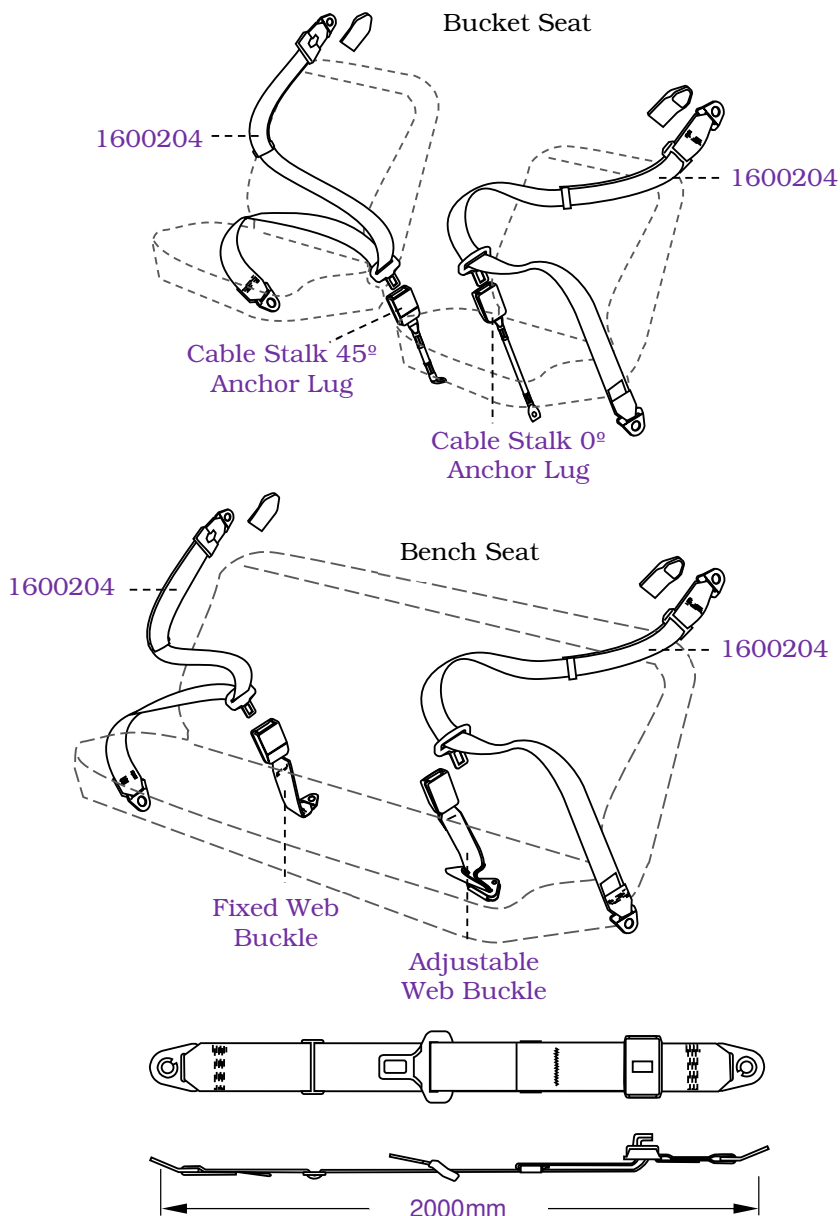

Seat Belt Assembly Part Numbers

Belt Part Number	Belt Type	Seating	Buckle Type	Buckle Part Number
1600204	Static Lap Sash	Bucket Seat	Stalk / Webbing	See Buckle Table Pg. 2

Note: Longer belts available, see below.

1600204S = 1700mm

1600204L = 2400mm

1600204XL = 2800mm

Designed for use with 1/2" bolts and fittings.

1600204 STATIC LAP SASH SEAT BELTS CONT'D

Cable Stalk Buckle Part Numbers					
Buckle Type & Position	230mm	300mm	330mm	350mm	400mm
0° Lug Driver or Passenger	1766014		1766026		1766033
45° Lug Passenger		1766099		1766097	1766090
45° Lug Driver		1766098		1766096	1766089

Note:
The below **1766026** example selection can be made by the following steps.
1. Choose a buckle type from the left hand column – **eg. 0° Lug Driver or Passenger**
2. Move along the corresponding row till you reach a suitable length – **eg. 330mm**
This should give a result of part number **1766026** as highlighted in the table.

0° Lug – Can be mounted to the side of the transmission tunnel.
45° Lug – Can be mounted to the floor

1766026 – 330mm Cable Stalk

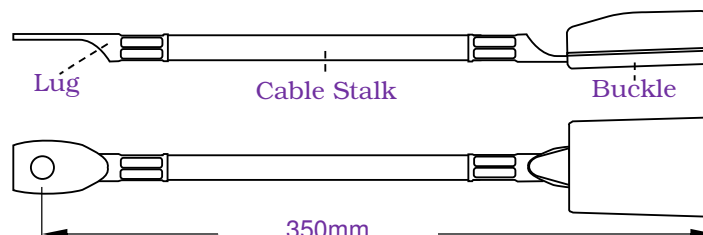

Webbing Buckle Part Numbers								
Buckle Type	Fixed Webbing Buckle Lengths							
	250mm	275mm	300mm	350mm	400mm	425mm	450mm	500mm
23° Anchor up	1765429	1765430	1765431	1765432	1765433	1765434	1765435	1765436
Adjustable Anchor	Adjustable Webbing Buckle Length. Adjustable from 200mm - 600mm							
	1765399							

Fixed Webbing Buckle

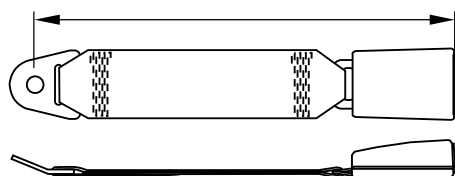

Adjustable Webbing Buckle

